

WA-215

Wall Mounted Amplifier with USB/FM and Bluetooth

Item ref: 953.132UK, 953.137UK

User Manual

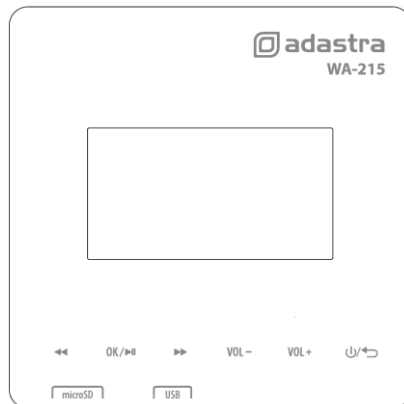

Version 1.0



Caution: Please read this manual carefully before operating
Damage caused by misuse is not covered by the warranty

Introduction

Thank you for choosing the Adastra WA-215 wall amplifier for your discreet audio installation. This unit is designed to provide a complete integrated solution for background music in rooms or corridors. Please read this manual to gain the best results from your product and avoid damage through misuse.

SAFETY SYMBOL AND MESSAGE CONVENTIONS



CAUTION
RISK OF ELECTRIC SHOCK
DO NOT OPEN

AVIS
RISQUE DE CHOC ELECTRIQUE NE PAS
OUVRIR



This symbol indicates that dangerous voltage constituting a risk of electric shock is present within this unit



This symbol indicates that there are important operating and maintenance instructions in the literature accompanying this unit.

Warning

To prevent the risk of fire or electric shock, do not expose any components to rain or moisture. If liquids enter the housing, disconnect the mains immediately, allow unit to dry out and have checked by qualified personnel before use. Avoid impact, extreme pressure or heavy vibration to the panel

No user serviceable parts inside

Do not open the case except for removing the front panel for installation

Refer all servicing to qualified service personnel.

Safety

- This product is powered directly from the mains supply and should only be fitted by a qualified electrical installer.

Placement

- The WA-215 can be installed into a partition wall using the supplied 58mm deep pattress box
- The WA-215 can be surface mounted if necessary, using the supplied or similar back box.
- Ensure adequate ventilation for cooling and keep away from combustible material or moisture
- Ensure that the WA-215 is within connection range of the sending device if using Bluetooth
- Do not set the panel fully into the wall and ensure adequate access to the bottom edge functions.

Cleaning

- Use a soft cloth with a neutral detergent to clean the panel as required
- Do not use solvents for cleaning the unit

Loudspeaker Installation

The WA-215 wall amplifier is available separately or as a WA-215-SET.

If supplied as a WA-215-SET, there are 2 ceiling speakers supplied.

The speakers may be installed into a plasterboard or tiled ceiling with at least 80mm to accommodate the mounting depth of each speaker.

The speakers should be wired to the WA-215 amplifier using standard twin speaker cable. 10m of suitable cable is supplied with the WA-215-SET and should be cut as required.

Carefully mark out and cut a hole 170mm diameter for each speaker. Feed the speaker wires from each hole to the WA-215 (passing through the back box)

Connect the + and - wires from the WA-215 speaker outputs to the 8Ω and COM screw terminals and offer the speaker to the hole in the ceiling with the spring clamps either side of the magnet pressed fully up to fit through the hole. The spring clamps will fold back down to hold the speaker in place. (see opposite)

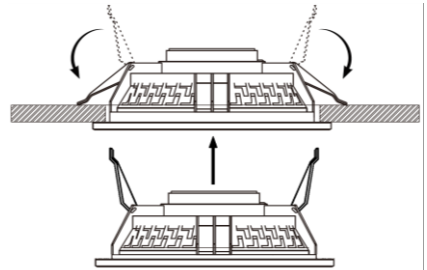

If the WA-215 is supplied without speakers, ensure that the load to be connected to each speaker output has no lower than 8Ω impedance and has a power handling of 15W max. Do not connect further speakers as this can cause damage to the WA-215 amplifier circuitry.

Back box installation

The WA-215 is supplied with a single gang 60mm deep back box and mounting plate for flush mounting or surface mounting to a wall. Install the back box to the chosen location and knock out any of the pre-punched discs in the sides for cable access as required.

Screw the mounting plate into the front of the back box and feed power, speaker, trigger and signal wires through the back box to the WA-215 and connect to the relative terminals (see "Connections" on the next page)

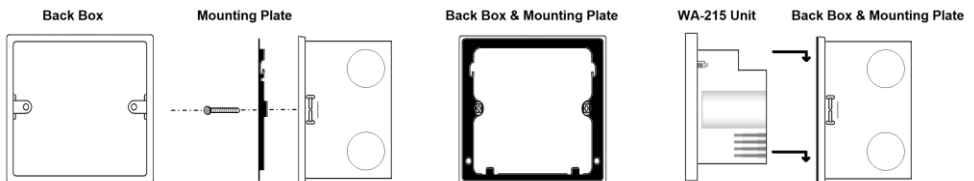

Alternatively, the mounting plate can be fitted into a standard 86 x 86mm pattress box top accommodate the WA-215, so long as there is a minimum 47mm mounting depth.

Connections

Connections to the WA-2150 are all made using the Euroblock screw terminals at the rear.

These terminals may be unplugged for convenience when inserting the wiring to them.

Ensure all speaker, FM aerial, remote play/doorbell, AUX input and isolated mains wiring is already fed through the wall and through the back box ready for connection to the WA-215 rear panel.

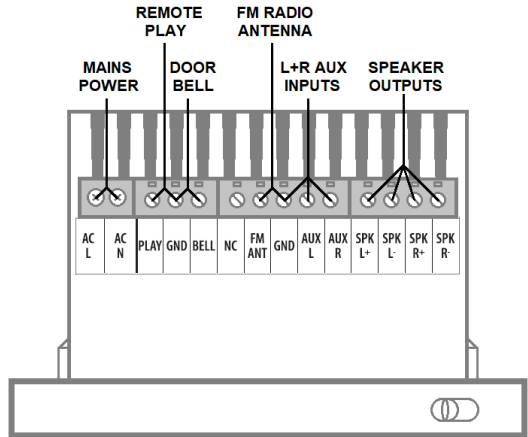

Connect left and right speaker wires to the relevant "+/-" terminals on the WA-215.

For better FM reception, an aerial may be connected to the FM ANT and GND terminals.

A line level input from an external audio source may be connected to the AUX terminals. These should be fed from the audio source to the WA-215 using shielded 2-core cable.

Connect Left+ and Right+ to the AUX L & R terminals and both Left- and Right- to GND

For remote play/pause control, a momentary switch may be connected to the REMOTE PLAY and GND terminals.

Likewise, a doorbell function is available by connecting a momentary switch to DOORBELL and GND.

Finally, with the mains isolated, connect Live and Neutral to the AC L and AC N terminals.

Plug in all Euroblock terminals before installing the WA-215 into the wall or back box. Feed the wiring carefully into the wall cavity to take up any excess, rather than compressing it inside the back box, which may damage the wire and connections.

Keep the mains power isolated (off) until the WA-215 is fully installed into the wall, covering the rear panel wiring.

If any function is not operating correctly once installed, isolate the mains power again before removing the WA-215 unit from the wall or back box. Re-check connections and carefully replace the WA-215 before switching the mains power back on.

Front Panel

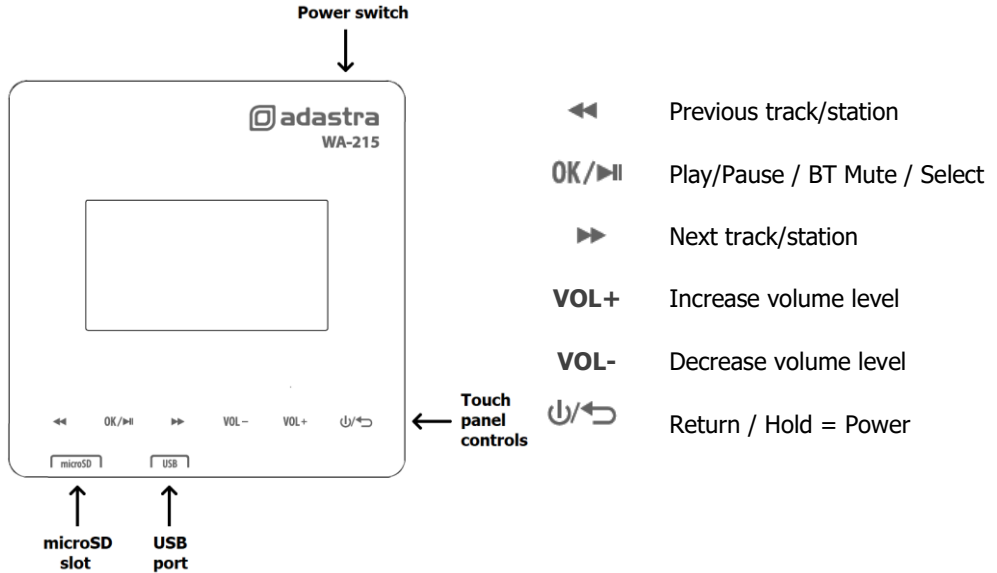

Bottom Edge



Top Edge

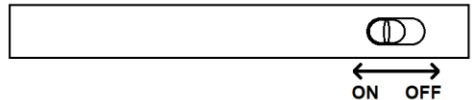

Operation

To power up the WA-215, slide the power switch on the top edge to the left position. The LCD screen will light up and show the welcome message (unless USB or SD media are connected). Touch the Return key to enter the menu.

The bottom edge of the WA-215 is home to a microSD slot and a USB port for inserting memory devices containing digital audio files to be played via the internal media player.

The front panel is completely flat with a row of touch-operated controls below the display. A brief description of each of these controls is given above.

Control is available from the front panel or via the supplied I.R. remote control handset. Insert 2 x AAA batteries into the rear compartment to use this remote.

Remote Control

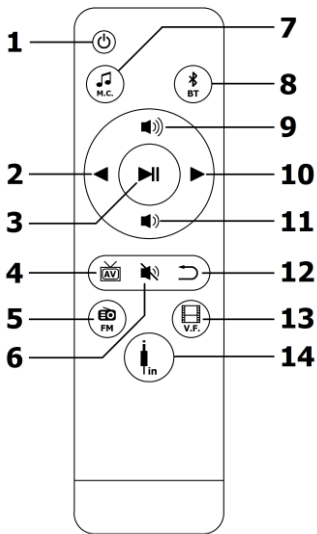

- 1 Power on/off
- 2 Previous track/station/option
- 3 Play/Pause / BT Mute / Select
- 4 - Not used -
- 5 FM tuner mode
- 6 Mute output
- 7 Music (USB/microSD) playback
- 8 Bluetooth Mode
- 9 Volume +
- 10 Next track/station/option
- 11 Volume -
- 12 Return
- 13 - Not used -
- 14 Line input mode

Main Menu

To access the main menu from power up or playback, touch or press the Return key until the set of icons shown below is displayed.

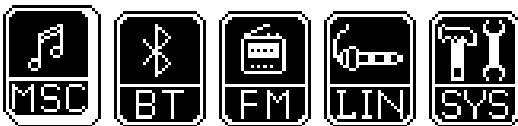

Use the Previous and Next keys to navigate through the menu options and press Play/Pause to select the required option.

Each icon has a sub menu which are described in each section on the following pages.

MSC (music) USB/SD Player

Insert a microSD or USB stick to the ports on the bottom edge of the faceplate and playback of audio files will begin automatically. If this does not happen, ensure that the media is formatted to FAT32 and the files stored onboard are supported types (see Specifications).

If the main menu screen is displayed, select the MSC option or press M.C. on the remote.

Note: If both microSD and USB media are connected, the last connected will take priority.

Touching Play/Pause on the face plate or remote will start or temporarily stop playback and stored tracks can be navigated using the Previous Track and Next Track keys.

The output volume level is adjusted using the Volume + / - buttons.

Playback Options

Holding the Play/Pause key on the faceplate during playback will enter the playback menu. Use Previous and Next keys to navigate options and Play/Pause to select.

Repeat	Equalizer	Local Folder	Delete File	Return
Repeat All	Natural	Root	Press Play/Pause to delete current track	
Repeat One	Rock	System Volume		
Repeat Folder	Pop	Track number select		
Random	Classic			
Return	Jazz			
	Country			
	Return			

Pressing the Return key returns to playback.
Pressing Return again reverts to main menu.

Bluetooth Mode

The WA-215 may be paired to a smart phone or tablet via Bluetooth for wireless playback. From the main menu, navigate to the second icon named "BT" and press Play/Pause. A musical note and the Bluetooth logo will appear on the screen.

Enable Bluetooth on the sending device and search for the device ID "Adastra WA-215". Select to pair with "Adastra WA-215" and when connected, an arrow is displayed pointing to another musical note to confirm that the connection is successful.

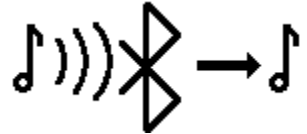

Play audio tracks on the sending device and check for output on the connected speakers. Ensure that the volume level on the sending device is not set too low or at zero.

Press Play/Pause to pause or continue playback. The display shows "MUTE" when paused. Previous and Next keys on the WA-215 will remotely navigate tracks on the sending device.

Press "Volume +" to increase volume or "Volume -" to decrease volume. Pressing Mute on the remote will also mute or un-mute the output.

Touching the Return key exits the Bluetooth mode and disconnects from the sending device. Enabling Bluetooth mode with a paired device in range will re-connect automatically.

FM Tuner

The WA-215 also has a built-in FM radio tuner. For best reception, it is advised to connect an FM antenna via the terminals at the rear of the main unit.

From the main menu, navigate to the FM icon and touch Play/Pause or press the FM button on the remote. The display will show "FM", the channel number and its FM frequency.

To initiate auto-tune to find available radio stations, touch and hold the Play/Pause key. The FM tuner will sweep through FM frequencies and store the strongest signals as pre-set channels. After auto-tuning, the Previous and Next keys will step through stored channels.

A short press on the Play/Pause key will mute or un-mute the FM tuner output. (a long press will re-tune all available channels again)

Press "Volume +" to increase volume or "Volume -" to decrease volume.

Touching the Return key exits the FM mode and reverts to the main menu.

Line Input

The terminal connections on the rear of the main unit include a stereo auxiliary line input, as described in the "Connections" section. To enable this input through the WA-215 amplifier from the main menu, navigate to the icon named "LIN" (line input) and a picture of a stereo phone plug will be displayed

Press "Volume +" to increase volume or "Volume -" to decrease volume.
Pressing Play/Pause (or Mute on the remote) will mute or un-mute the output.

Touching the Return key exits the FM mode and reverts to the main menu.

System Menu

From the main menu, navigate to the SYS icon (far right) and touch Play/Pause.
Use Previous and Next to navigate options and Play/Pause to select from the options below.

Backlight	Language	Contrast	Firmware Ver.	Return
0 sec.	English	0 - 19	Firmware version No.	
10 sec.	Return			
0 sec.				
1 min.				
2 min.				
5 min.				
10 min.				
Return				

Backlight adjusts the time that the LCD backlight stays lit after no keys are pressed/touched.
Note: a value of "0" seconds means that the backlight will stay lit and not switch off.

Contrast adjusts the brightness depth of the LCD display via a sliding bar setting.

Firmware Ver. Displays the firmware version of the WA-215

Specifications: WA-215

Power supply	100-240Vac, 50/60Hz (euroblock terminals)
Output	2 x 15W @ 8 ohms (euroblock terminals)
Audio source	USB / microSD player, FM tuner and Bluetooth receiver
Auxiliary input	Left + right line in (euroblock terminals)
Audio format	mp3, wma, wav
FM : tuning range	87.5 - 108MHz
Bluetooth range	Up to 10m
Frequency response	20Hz - 20kHz (± 3 dB)
THD	<0.03% at 1kHz, 1W
S/N ratio	>98dB
Trigger	Remote playback and door bell (euroblock terminals)
Mounting depth	47mm (with adequate ventilation, 57mm box supplied)
Dimensions	86 x 86 x 50mm
Weight	150g

Specifications: Ceiling Speakers (WA-215-SET)

Driver	165mm \varnothing (6.5") dual reinforced paper cone
Rated power handling	15W
Impedance	8 Ω
Frequency response	100Hz – 15kHz
SPL	93dB (1W, 1m)
Material	ABS with metal grille and reinforced paper cone
Cutout	170mm \varnothing
Dimensions	76 x 188mm \varnothing
Weight	700g (each)



Disposal: The "Crossed Wheelie Bin" symbol on the product means that the product is classed as Electrical or Electronic equipment and should not be disposed with other household or commercial waste at the end of its useful life. The goods must be disposed of according to your local council guidelines.

*Errors and omissions excepted.
Copyright© 2019. AVSL Group Ltd.*